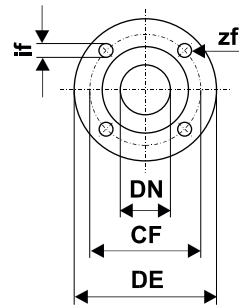

MOTORE ELETTRICO - ELECTRIC MOTOR

Grandezza Size IEC	Potenza in [kW] Power in [kW]			$L^{(a)}$ [mm]	Peso Weight ^(a) [kg]
	2 Poli 2 Poles	4 Poli 4 Poles	6 Poli 6 Poles		
	80	0.75	0.55		
80	1.1	0.75	0.55	232	10
90	1.5	1.1	0.75	270	13
90	2.2	1.5	1.1	270	16
100	3	2.2	1.5	298	21
100	-	3	-	298	23
112	4	4	2.2	312	30
132	5.5	5.5	3	381	40
132	7.5	7.5	4	381	50
132	9.2	9.2	5.5	381	50
160	11	11	7.5	486	76
160	15	15	11	486	85
160	18.5	-	-	486	95
180	22	18.5	15	576	130
180	-	22	-	576	145

Dimensioni Flange - Flange Dimensions EN 1092-1 PN 16

DNa - DNm	32	40	50	65	80	100	125	150
CF	100	110	125	145	160	180	210	240
DE	140	150	165	185	200	220	250	285
if	18	18	18	18	18	18	18	22
zf	4	4	4	4	8	8	8	8

Pompa Tipo Pump size	Motore elettrico Electric motor IEC	DIMENSIONI - DIMENSIONS [mm]															Peso Weight ^(a) [kg]		
		Pompa - Pump						Piedi - Feet											
		DNa	DNm	a	f	h1	h2	b	m1	m2	n1	n2	n3	w	c	c1		S1	S2
32-16	80	50	32	80	437	132	160	50	100	70	240	190	110	395	14	-	14	14	42
	90	"	"	"	437	"	"	"	"	"	"	"	"	"	"	"	"	"	42
	100	"	"	"	457	"	"	"	"	"	"	"	"	"	"	"	"	"	46
	112	"	"	"	457	"	"	"	"	"	"	"	"	"	"	"	"	"	46
	132	"	"	"	477	"	"	"	"	"	"	"	190	435	"	25	"	"	48
32-20	80	50	32	80	437	160	180	50	100	70	240	190	110	395	14	-	14	14	48
	90	"	"	"	437	"	"	"	"	"	"	"	"	"	"	"	"	"	48
	100	"	"	"	457	"	"	"	"	"	"	"	"	"	"	"	"	"	52
	112	"	"	"	457	"	"	"	"	"	"	"	"	"	"	"	"	"	52
	132	"	"	"	477	"	"	"	"	"	"	"	190	435	"	"	"	"	54
	160	"	"	"	507	"	"	"	"	"	"	"	"	456	"	20	"	"	61
40-16	80	65	40	80	437	132	160	50	100	70	240	190	110	395	14	-	14	14	43
	90	"	"	"	437	"	"	"	"	"	"	"	"	"	"	"	"	"	43
	100	"	"	"	457	"	"	"	"	"	"	"	"	"	"	"	"	"	47
	112	"	"	"	457	"	"	"	"	"	"	"	"	"	"	"	"	"	47
	132	"	"	"	477	"	"	"	"	"	"	"	190	435	"	25	"	"	49
	160	"	"	"	507	"	"	"	"	"	"	"	"	"	"	50	"	"	56

Quote e pesi suscettibili di variazione.
 Dimensions and weights are subject to variations.

^(a)Quota indicativa può variare in funzione della marca del motore
 Not binding dimension that can change according to motor brand

^(b)Peso senza motore elettrico
 Weight without electric motor



**SALVATORE
ROBUSCHI
POMPE PARMA**

INGOMBRI LANTERNATA

**LANTERN BRACKET PUMP
OVERALL DIMENSIONS**

**RDL
RGL**

N : T-1141

DATA: 17.10.2011

Pompa Tipo Pump size	Motore elettrico Electric motor IEC	DIMENSIONI - DIMENSIONS [mm]																Peso Weight ^(b) [kg]	
		Pompa - Pump						Piedi - Feet											
		DNa	DNm	a	f	h1	h2	b	m1	m2	n1	n2	n3	w	c	c1	S1		S2
40-20	80	65	40	100	437	160	180	50	100	70	265	212	110	395	14	-	14	14	47
	90	"	"	"	437	"	"	"	"	"	"	"	"	"	"	"	"	"	47
	100	"	"	"	457	"	"	"	"	"	"	"	"	"	"	"	"	"	51
	112	"	"	"	457	"	"	"	"	"	"	"	"	"	"	"	"	"	51
	132	"	"	"	477	"	"	"	"	"	"	"	"	190	437	"	-	"	53
160	"	"	"	507	"	"	"	"	"	"	"	"	190	456	"	20	"	60	
50-16	80	80	50	100	437	160	180	50	100	70	265	212	110	395	14	-	14	14	46
	90	"	"	"	437	"	"	"	"	"	"	"	"	"	"	"	"	"	46
	100	"	"	"	457	"	"	"	"	"	"	"	"	"	"	"	"	"	50
	112	"	"	"	457	"	"	"	"	"	"	"	"	"	"	"	"	"	50
	132	"	"	"	477	"	"	"	"	"	"	"	"	190	435	"	-	"	52
160	"	"	"	507	"	"	"	"	"	"	"	"	190	456	"	20	"	59	
50-20	90	80	50	100	437	160	200	50	100	70	265	212	110	395	14	-	14	14	51
	100	"	"	"	457	"	"	"	"	"	"	"	"	"	"	"	"	"	55
	112	"	"	"	457	"	"	"	"	"	"	"	"	"	"	"	"	"	55
	132	"	"	"	477	"	"	"	"	"	"	"	"	190	437	"	-	"	57
	160	"	"	"	507	"	"	"	"	"	"	"	"	190	456	"	20	"	64
50-25	100	80	50	125	563	180	225	65	125	95	320	250	110	516	16	-	16	14	80
	112	"	"	"	563	"	"	"	"	"	"	"	"	"	"	"	"	"	80
	132	"	"	"	583	"	"	"	"	"	"	"	"	190	543	"	-	"	84
	160	"	"	"	613	"	"	"	"	"	"	"	"	212	562	"	-	"	89
	65-16	100	100	65	100	563	160	200	65	125	95	280	212	110	516	15	-	14	14
112		"	"	"	563	"	"	"	"	"	"	"	"	"	"	"	"	"	69
132		"	"	"	583	"	"	"	"	"	"	"	"	190	543	"	-	"	73
160		"	"	"	613	"	"	"	"	"	"	"	"	212	562	"	20	"	78
65-20		100	100	65	100	563	180	225	65	125	95	320	250	110	516	16	-	14	14
	112	"	"	"	563	"	"	"	"	"	"	"	"	"	"	"	"	"	77
	132	"	"	"	583	"	"	"	"	"	"	"	"	190	543	"	-	"	81
	160	"	"	"	613	"	"	"	"	"	"	"	"	212	562	"	-	"	86
	65-25	100	100	65	125	563	200	250	80	160	120	360	280	110	516	18	-	18	14
112		"	"	"	563	"	"	"	"	"	"	"	"	"	"	"	"	"	87
132		"	"	"	583	"	"	"	"	"	"	"	"	190	536	"	-	"	91
160		"	"	"	613	"	"	"	"	"	"	"	"	212	568	"	-	"	96
65-31		112	100	65	125	598	225	280	80	160	120	400	315	110	549	18	-	18	14
	132	"	"	"	618	"	"	"	"	"	"	"	"	190	579	"	-	"	125
	160	"	"	"	648	"	"	"	"	"	"	"	"	212	598	"	-	"	130
	180	"	"	"	648	"	"	"	"	"	"	"	"	"	"	"	-	"	135
	80-16	100	125	80	125	563	180	225	65	125	95	320	250	110	516	15	-	14	14
112		"	"	"	563	"	"	"	"	"	"	"	"	"	"	"	"	"	76
132		"	"	"	583	"	"	"	"	"	"	"	"	190	543	"	-	"	80
160		"	"	"	613	"	"	"	"	"	"	"	"	212	562	"	-	"	85
80-20		100	125	80	125	563	180	250	65	125	95	345	280	110	516	16	-	14	14
	112	"	"	"	563	"	"	"	"	"	"	"	"	"	"	"	"	"	81
	132	"	"	"	583	"	"	"	"	"	"	"	"	190	543	"	-	"	85
	160	"	"	"	613	"	"	"	"	"	"	"	"	212	562	"	-	"	91
	80-25	100	125	80	125	563	225	280	80	160	120	400	315	110	516	18	-	18	14
112		"	"	"	563	"	"	"	"	"	"	"	"	"	"	"	"	"	96
132		"	"	"	583	"	"	"	"	"	"	"	"	190	543	"	-	"	100
160		"	"	"	613	"	"	"	"	"	"	"	"	212	562	"	-	"	105
80-31		112	125	80	125	598	250	315	80	160	120	400	315	110	549	18	-	18	14
	132	"	"	"	618	"	"	"	"	"	"	"	"	190	579	"	-	"	139
	160	"	"	"	648	"	"	"	"	"	"	"	"	212	598	"	-	"	143
	180	"	"	"	648	"	"	"	"	"	"	"	"	"	"	"	-	"	148
	100-20	100	125	100	125	563	200	280	80	160	120	360	280	110	516	16	-	18	14
112		"	"	"	563	"	"	"	"	"	"	"	"	"	"	"	"	"	96
132		"	"	"	583	"	"	"	"	"	"	"	"	190	543	"	-	"	100
160		"	"	"	613	"	"	"	"	"	"	"	"	212	562	"	-	"	105
180		"	"	"	613	"	"	"	"	"	"	"	"	"	"	"	-	"	105
100-25	100	125	100	140	598	225	280	80	160	120	400	315	110	551	18	-	18	14	126
	112	"	"	"	598	"	"	"	"	"	"	"	"	"	"	"	"	"	126
	132	"	"	"	618	"	"	"	"	"	"	"	"	190	579	"	-	"	130
	160	"	"	"	648	"	"	"	"	"	"	"	"	212	594	"	-	"	135
	180	"	"	"	648	"	"	"	"	"	"	"	"	"	"	"	-	"	135
100-31	100	125	100	140	598	250	315	80	160	120	400	315	110	551	18	-	18	14	146
	112	"	"	"	598	"	"	"	"	"	"	"	"	"	"	"	"	"	146
	132	"	"	"	618	"	"	"	"	"	"	"	"	190	579	"	-	"	150
	160	"	"	"	648	"	"	"	"	"	"	"	"	212	594	"	-	"	155
	180	"	"	"	648	"	"	"	"	"	"	"	"	"	"	"	-	"	155
125-25	112	150	125	140	598	250	355	80	160	120	400	315	110	551	18	-	18	14	148
	132	"	"	"	618	"	"	"	"	"	"	"	"	190	579	"	-	"	152
	160	"	"	"	648	"	"	"	"	"	"	"	"	212	594	"	-	"	157
	180	"	"	"	648	"	"	"	"	"	"	"	"	"	"	"	-	"	157
	125-31	112	150	125	140	598	280	355	100	200	150	500	400	110	551	20	-	23	14
132		"	"	"	618	"	"	"	"	"	"	"	"	190	579	"	-	"	168
160		"	"	"	648	"	"	"	"	"	"	"	"	212	594	"	-	"	173
180		"	"	"	648	"	"	"	"	"	"	"	"	"	"	"	-	"	173

Quote e pesi suscettibili di variazione.
Dimensions and weights are subject to variations.

^(b)Peso senza motore elettrico
Weight without electric motor